

SUPERYACHT TENDER FENDERS

MAXIMUM PROTECTION FOR YOUR TENDERS

After an extensive design phase with lengthy consultation from yacht captains and deck crew, C-Quip International has developed a new range of carbon fibre tender fender products to suit any yacht and any tender. These new products complement C-Quip's extensive range of boarding and tender handling equipment.

Whilst every yacht will require some customisation of these designs to suit the transom profile, the choice of product will depend on the tender type and weight.

- **Fully customised tender fenders are available for yachts with unique requirements**

Each tender fender frame is made from pre-preg carbon fibre which has been optimised with the help of extensive computer simulation to achieve maximum rigidity at the minimum weight.

The fenders can be locked in place using either the yacht's existing sockets or custom designed units.

All frames are designed to make handling and storage of these large items much easier for the crew.

C-QUIP TENDER FENDER

- Intelligent design – maximum management of impact loads
- Maximum protection for the tender, passengers and crew
- Light-weight, strong and durable construction
- Easy handling by crew
- Clear coat carbon fibre or yacht colour scheme
- Fender available in a variety of colours
- Customised to the yacht transom profile

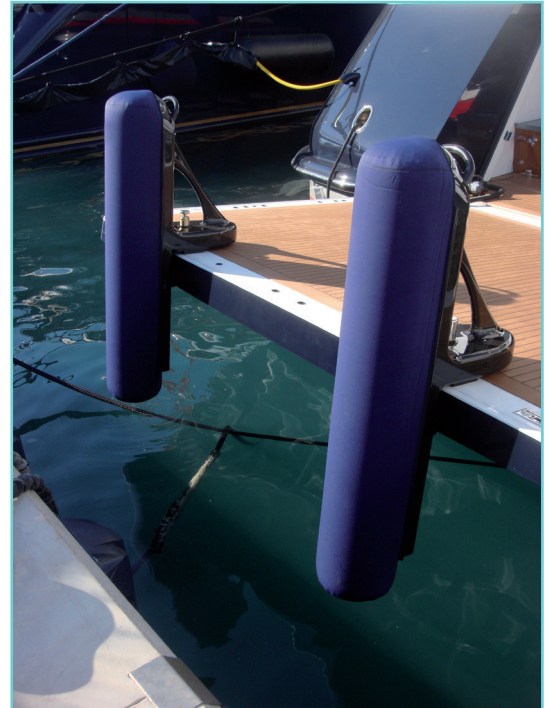

SlimLine Tender
Fender



Standard Tender
Fender

SUPERYACHT TENDER FENDERS

BOARDING STAIRS

TENDER BOOMS

LIGHTMASTS

TENDER FENDERS

SWIM STAIRS

PILOT LADDERS

SWIM LADDERS

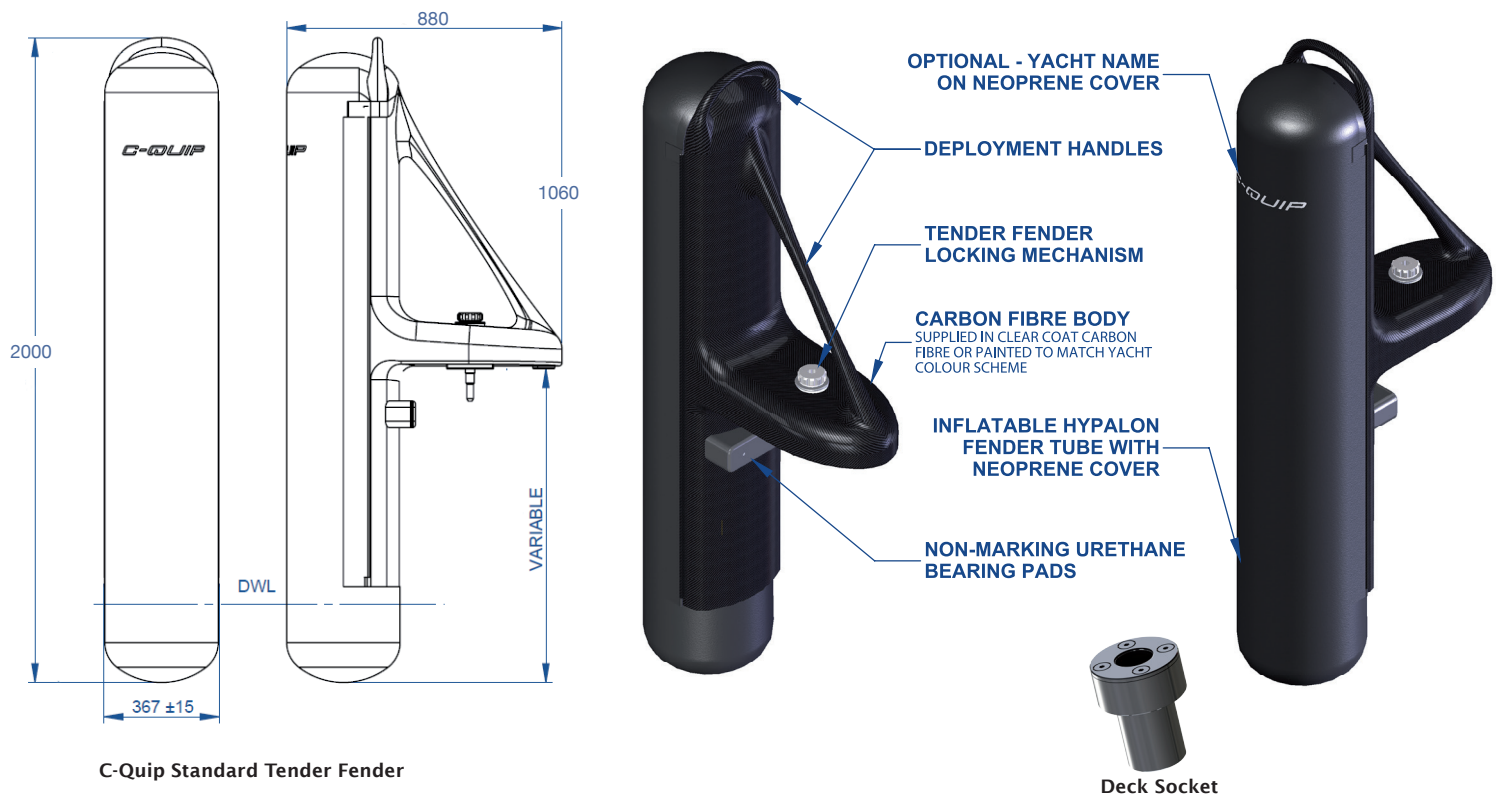

The carbon fibre tender fender bracket simplifies protecting and stowing the units. The bracket attached to the wall supports the tender fender by locking the fenders into the unit.

TECHNICAL INFORMATION

CONSTRUCTION

Fender Style:	Inflated Hypalon
Length:	2000mm
Width:	367mm
Weight:	25kg
Tender Weight:	< 10 tonnes
Available Finish:	Clear coat carbon fibre or yacht colour scheme
Fender Colour:	Available in a variety of colours
Deck Fittings:	Highly polished 316 stainless steel